

**Shuttles
LSC/LC/SC**

Type	LSC	LSC-Tele.	LSC-SbS	LC	LC-Turn	SC	Unit
General information							
Belt support width A ⁽⁰¹⁾	1050	1050	1050	800	1050	1050	mm
Belt support width A	1330	1170	1330	1050	1330	1330	mm
Belt support width A				1330			mm
Width B ⁽⁰²⁾							
Standard	490	490	460	480	230	490	mm
with horizontal stroke	570	—	540	560	310	570	mm
with scale	666	—	636	656	406	666	mm
Belt support length C ⁽⁰³⁾	15 - 39	15 - 23	15 - 39	15 - 39	15 - 39	15 - 39	dm
Transfer height Dmax ⁽⁰⁴⁾	4500	3500	4500	5500	5500	2000	mm
Take-over height Emin	280	400	280	150	310	280	mm
Height F	1200	2450	1200	1200	1200	—	mm
Guide plate height G ⁽⁰⁵⁾	300-900	300-500	300-900	300-900	300-900	300-900	mm
Dimensions							
Machine / transport dimensions (WxHxD)	Variable						mm
Infeed opening (WxH)	Variable						mm
Weights							
Operating / transport weight	Variable						kg
Miscellaneous							
Horizontal stroke H	400-700	—	400-700	400-800	400-700	400-700	mm
Lifting speed ⁽⁰⁶⁾	15	15	15	15	15	—	m/min
Belt speed ⁽⁰⁷⁾	18	18	18	18	18	18	m/min
Traverse speed ⁽⁰⁸⁾	40	40	40	—	—	40	m/min
Angle of oscillation	—	—	—	—	90	—	°

(01) With telescope variant, bottom belt support 1170 mm and top belt support 1050 mm

(02) The width depends on the use of horizontal stroke or a scale (optional)

(03) Length can be adjusted in 200 mm increments

(04) A support is required for higher values

(05) Guide plate height can be changed in 100 mm increments

(06) Optional 25 m/min, with manual loading, lowering with 6 m/min

(07) For 1330 mm belts, transfer speed 30 m/min

(08) Option 60 m/min

All rights for technical modifications withheld

**Shuttles
LSC**

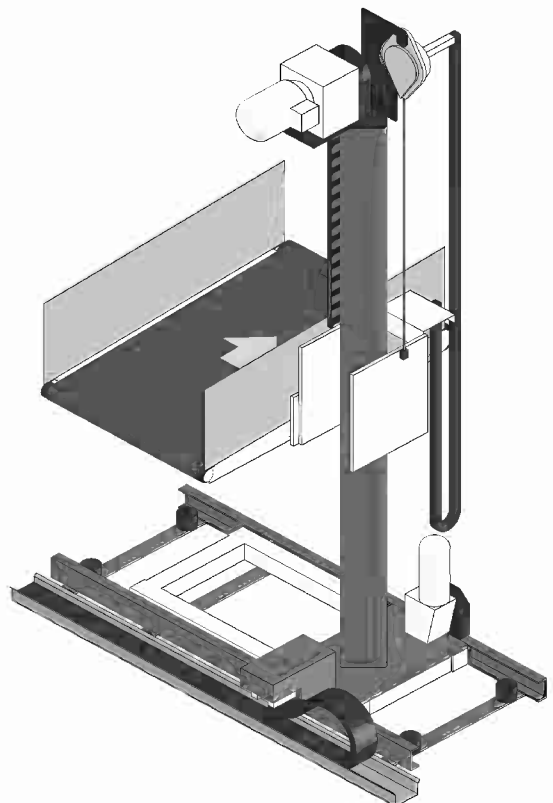
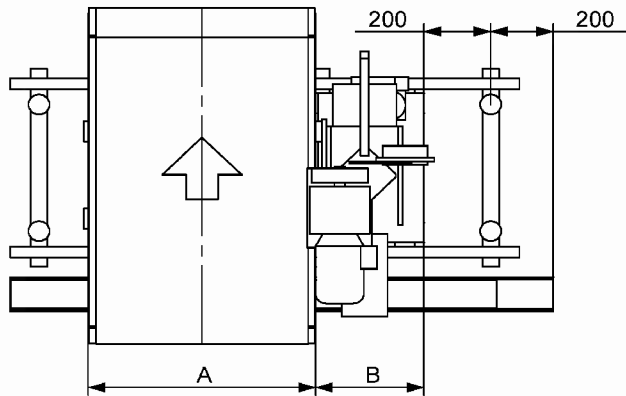
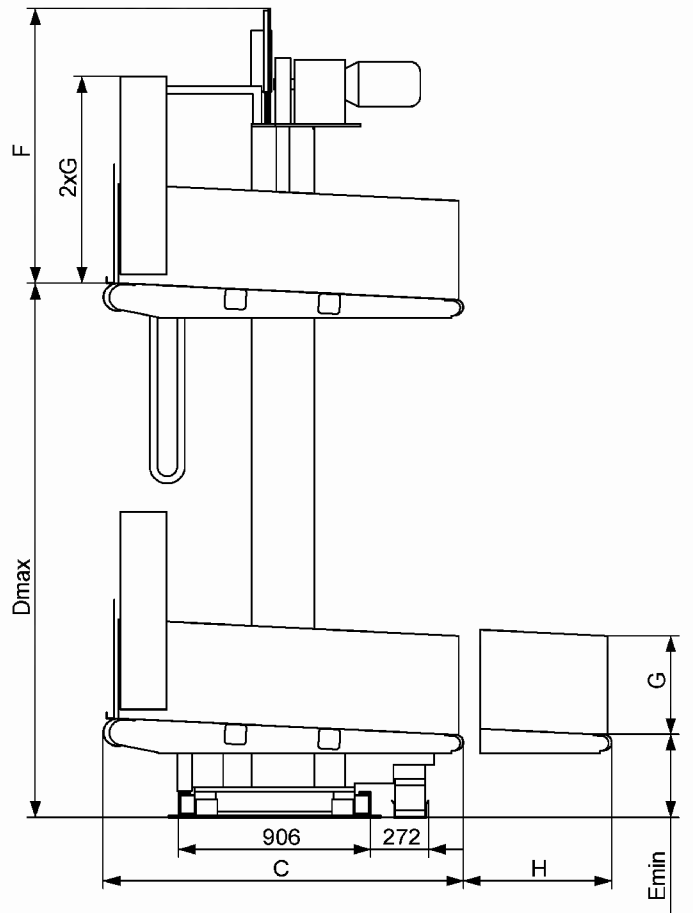
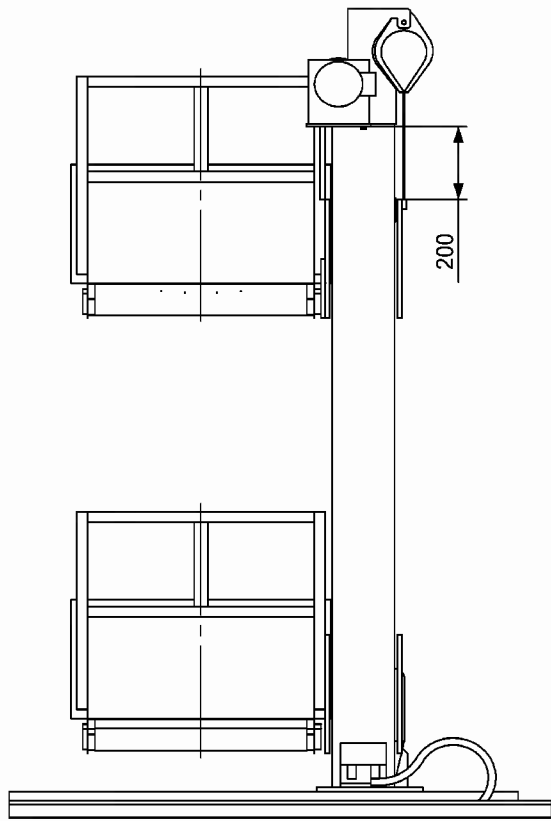

Attention! This sketch is not true to scale. Options may be included in this display. All rights for technical modifications withheld.

**Shuttles
LSC-Telescope**

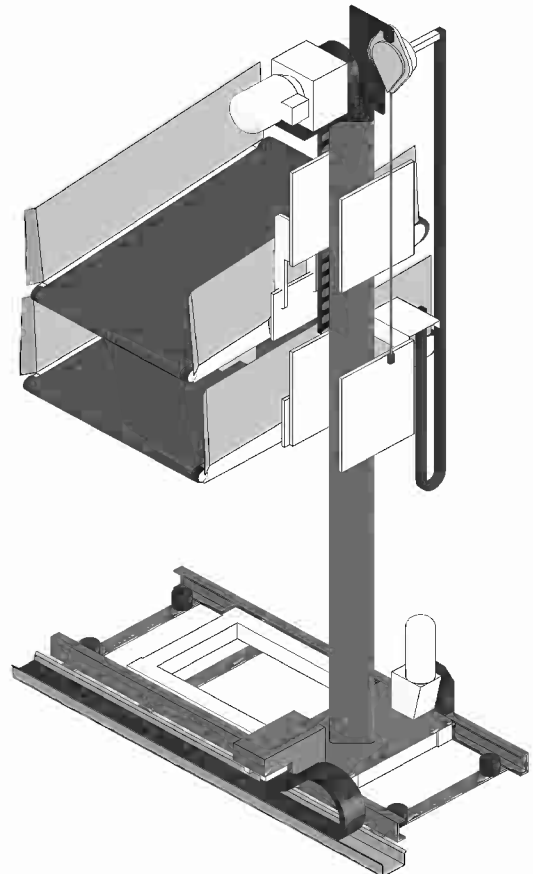
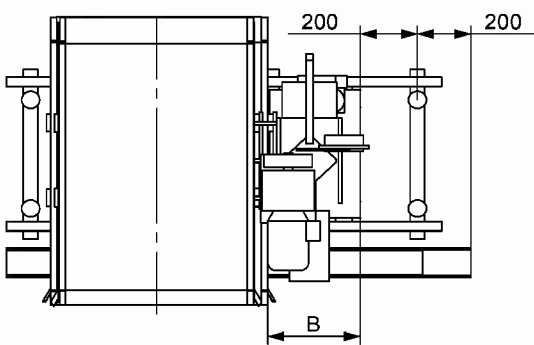
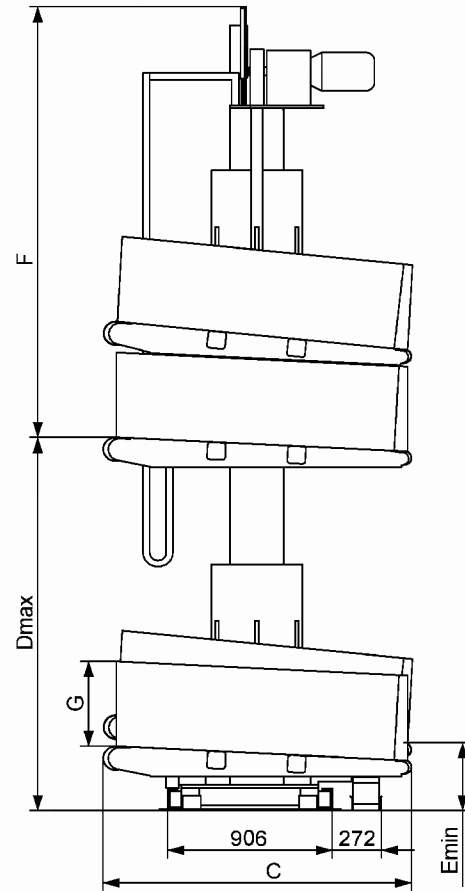
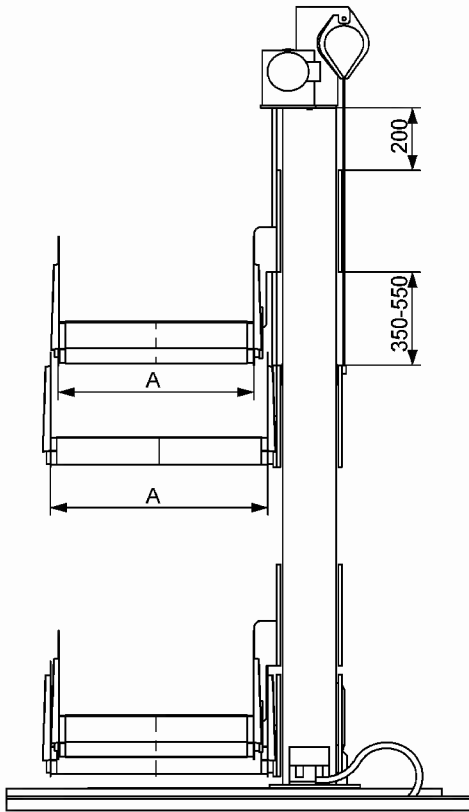

Attention! This sketch is not true to scale. Options may be included in this display. All rights for technical modifications withheld.

Shuttles LSC - Side by Side

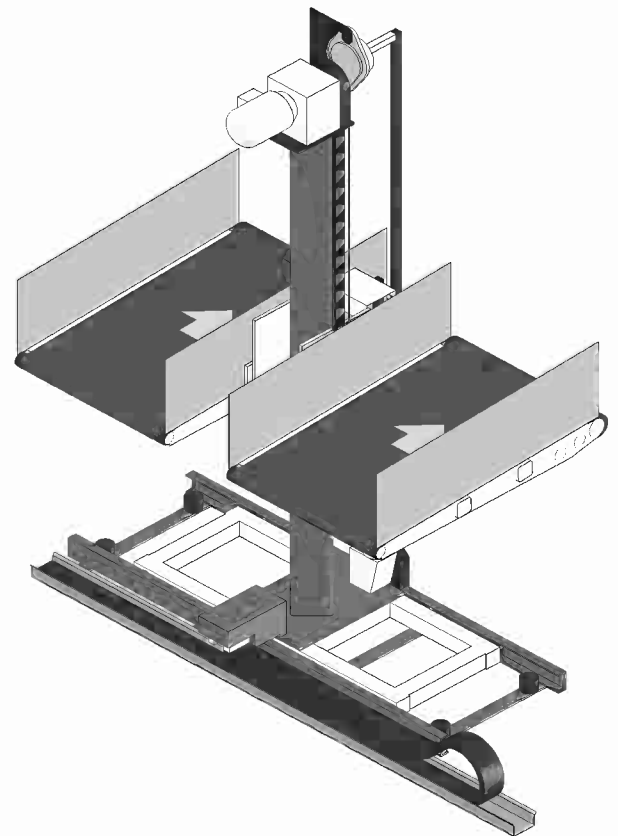
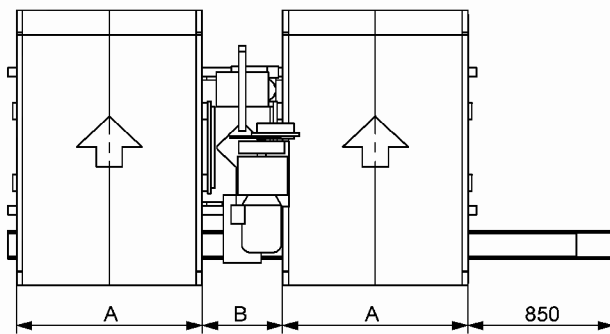
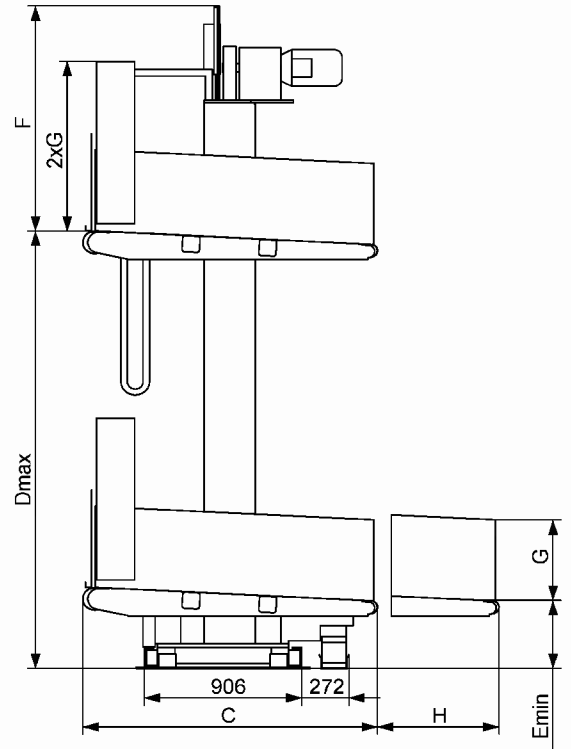
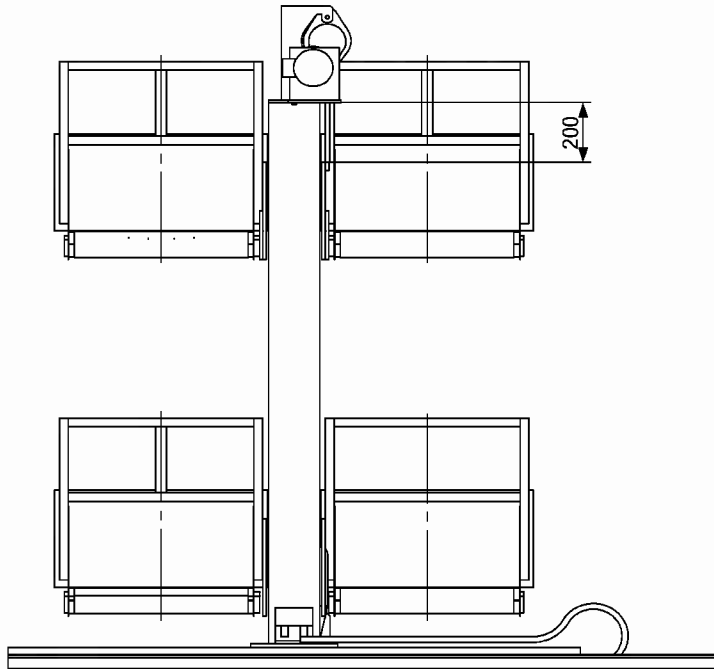

Attention! This sketch is not true to scale. Options may be included in this display. All rights for technical modifications withheld.

**Shuttles
LC**

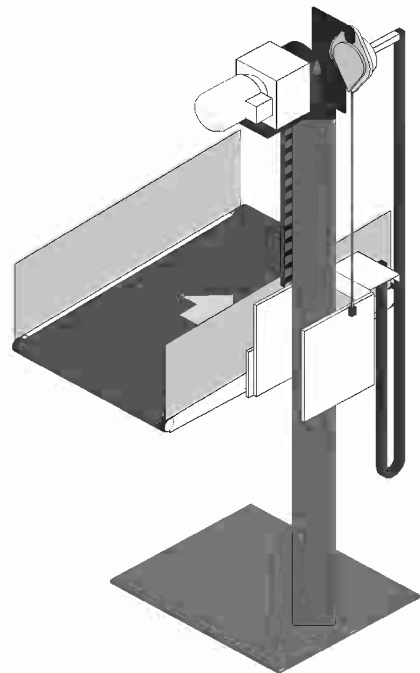
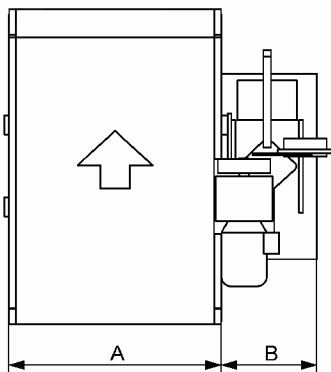
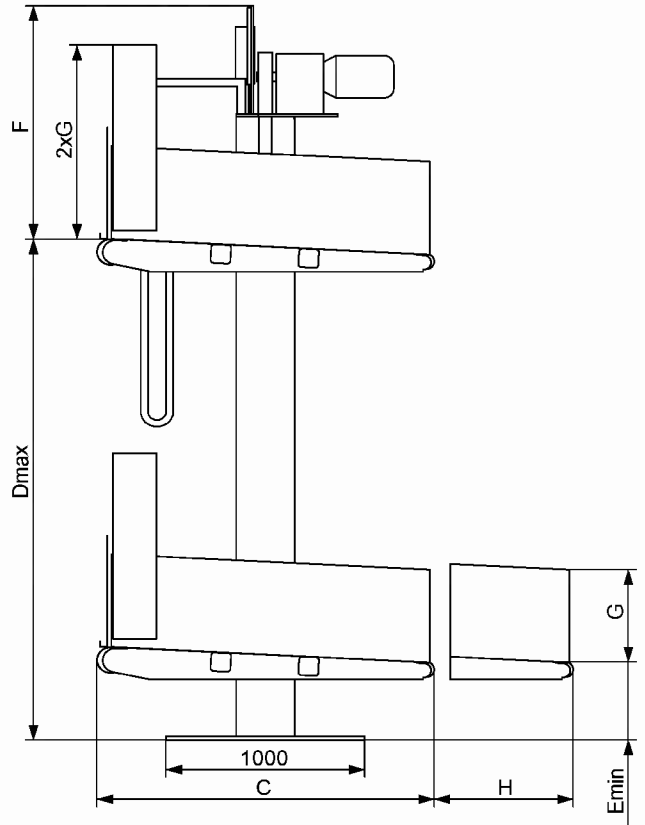
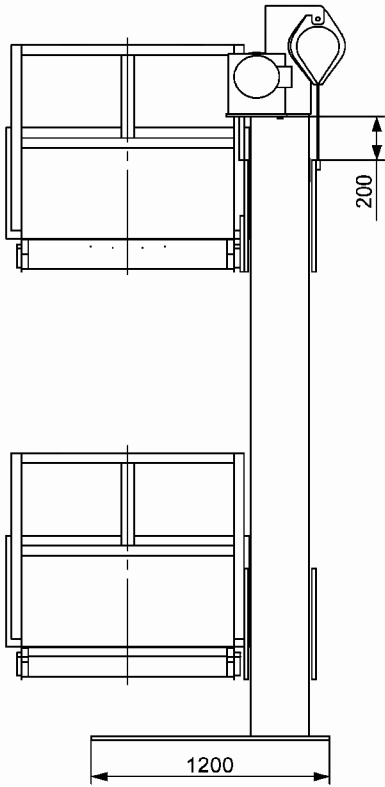

Attention! This sketch is not true to scale. Options may be included in this display. All rights for technical modifications withheld.

**Shuttles
LC-Turn**

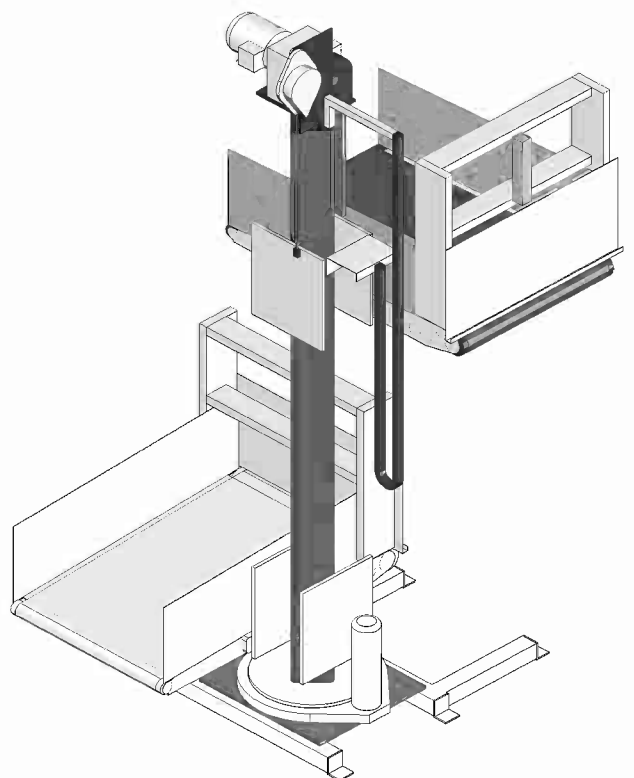
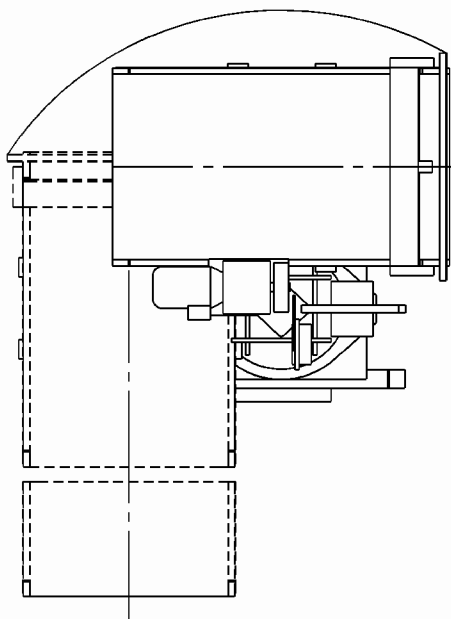
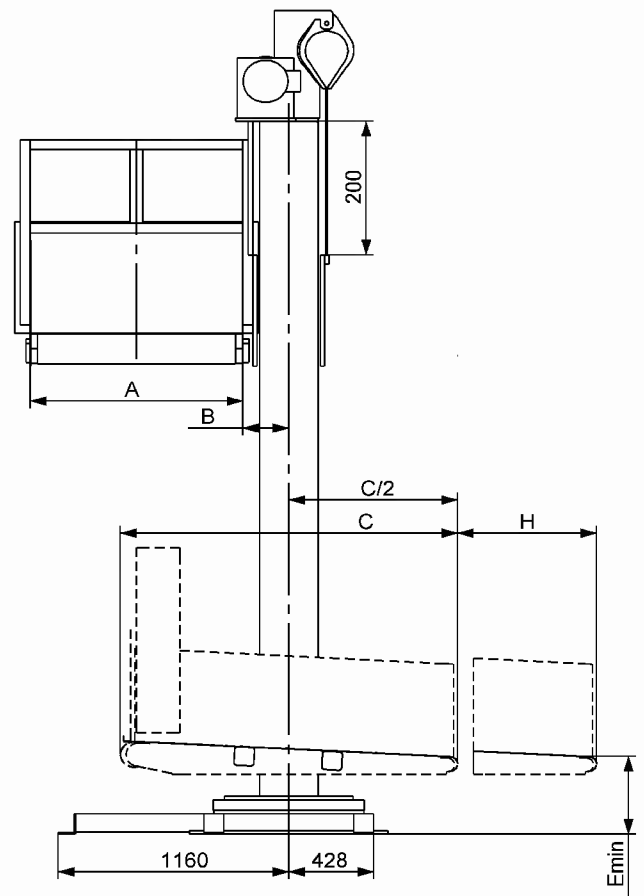
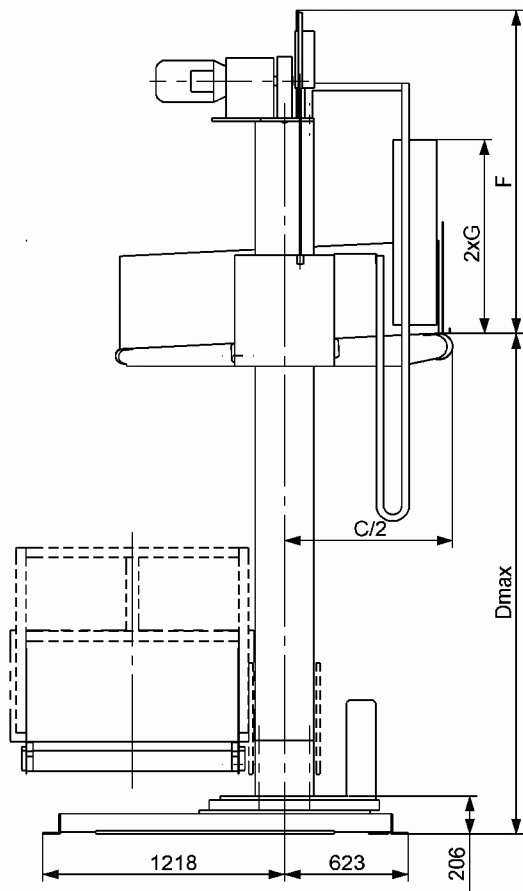

Attention! This sketch is not true to scale. Options may be included in this display. All rights for technical modifications withheld.

**Shuttles
SC**

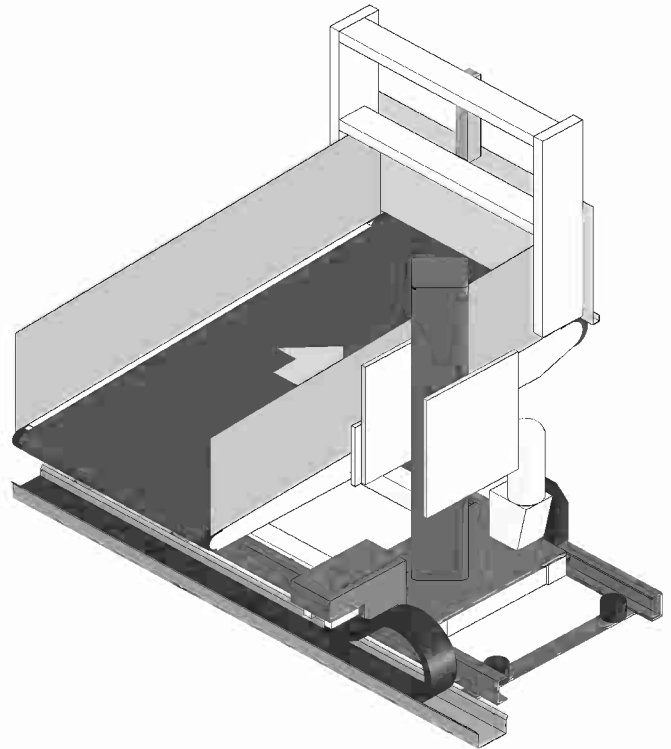
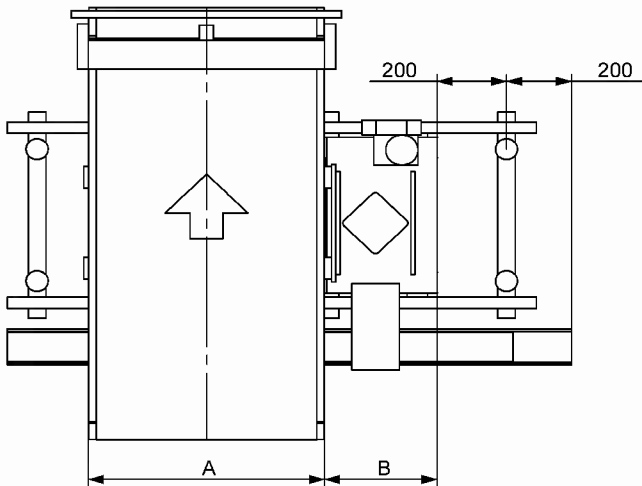
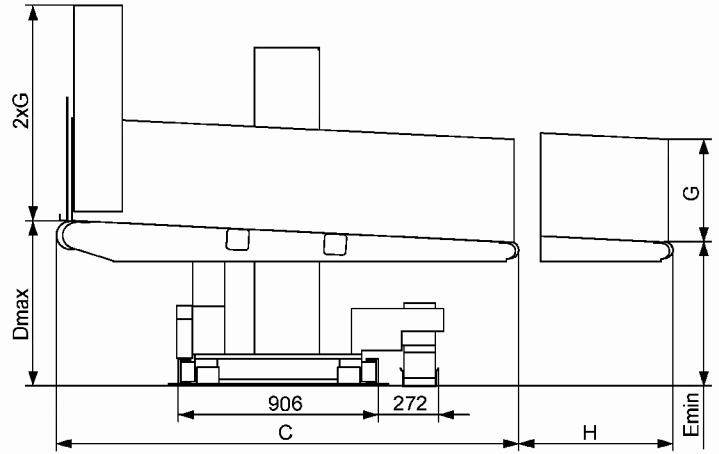
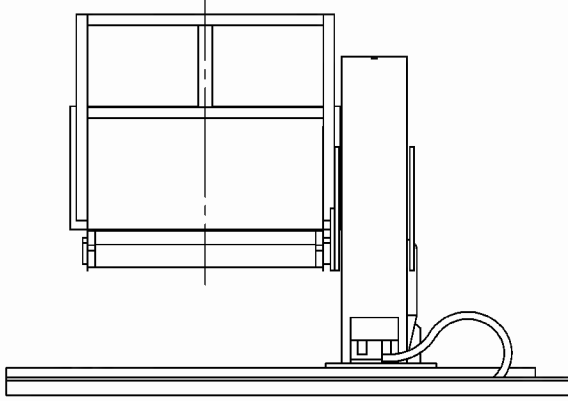

Attention! This sketch is not true to scale. Options may be included in this display. All rights for technical modifications withheld.